



PRESS RELEASE

Date: March 10, 2016
Contacts: Eliza Echevarria Perez, Public Affairs Manager
(951) 787-7141 – Office or (951) 235-9564 – Mobile

FOR IMMEDIATE RELEASE

91 Project Construction Work to be Rescheduled, due to Rain Forecast

Anticipated rain has caused the Riverside County Transportation Commission (RCTC) to reschedule two work activities scheduled for this weekend.

The one-night full closure of the eastbound and westbound 91 connectors to northbound 71, originally scheduled to start on Friday night, has been rescheduled to occur from Saturday, March 12 at 10 pm to Sunday, March 13 at 6:30 am. The southbound 71 to eastbound and westbound 91 connectors will remain open.

The closure is necessary to allow crews to grind, pave and stripe the roadway. Motorists may use the 15, 57 and 60 during the closure of the connectors. See detour map on page 3.

The 55-hour weekend closure of Serfas Club Drive, previously scheduled for March 11-14, has been rescheduled to occur from Friday, March 18 at 9 pm to Monday, March 21 at 4 am. Serfas Club Drive will be closed between Frontage Road and the westbound 91 ramps. The eastbound 91 off-ramp also will be closed, along with the eastbound 91 on-ramp, which closed in September for approximately 15 months. .

This is the second of three closure phases needed to lower Serfas Club Drive to meet truck clearance requirements. Crews also will relocate utilities and build new sidewalks, curbs and gutters during the closure.

The third phase will require a nine-day full closure of the underpass and remains on schedule for late March. To reduce the impact to motorists, the closure is scheduled during the Corona-Norco Unified

-- MORE --

School District spring break, when fewer motorists are on the road. Please see detour map on page 4. All Maple Street on-ramps and off-ramps will be open during the underpass closure.

During this time and throughout construction, motorists are reminded to follow the posted reduced 55 mile per hour speed limit within the 91 Project construction zone, allow extra travel time, follow detour signs, and carpool or use public transit, when feasible.

The 91 Project is adding regular lanes, tolled express lanes, auxiliary lanes and direct express connectors from the northbound 15 to the westbound 91 and from the eastbound 91 to the southbound 15. Improvements to interchanges, ramps, lanes and surface streets also will be made along the 91 between the Riverside County/Orange County Line in Corona and Pierce Street in Riverside. The new lanes are expected to open in 2017.

For more information, visit sr91project.info, call the helpline at 877-770-9191, or email sr91project@rctc.org.

###

91 PROJECT DETOUR

91 Connectors to Northbound 71 Closed

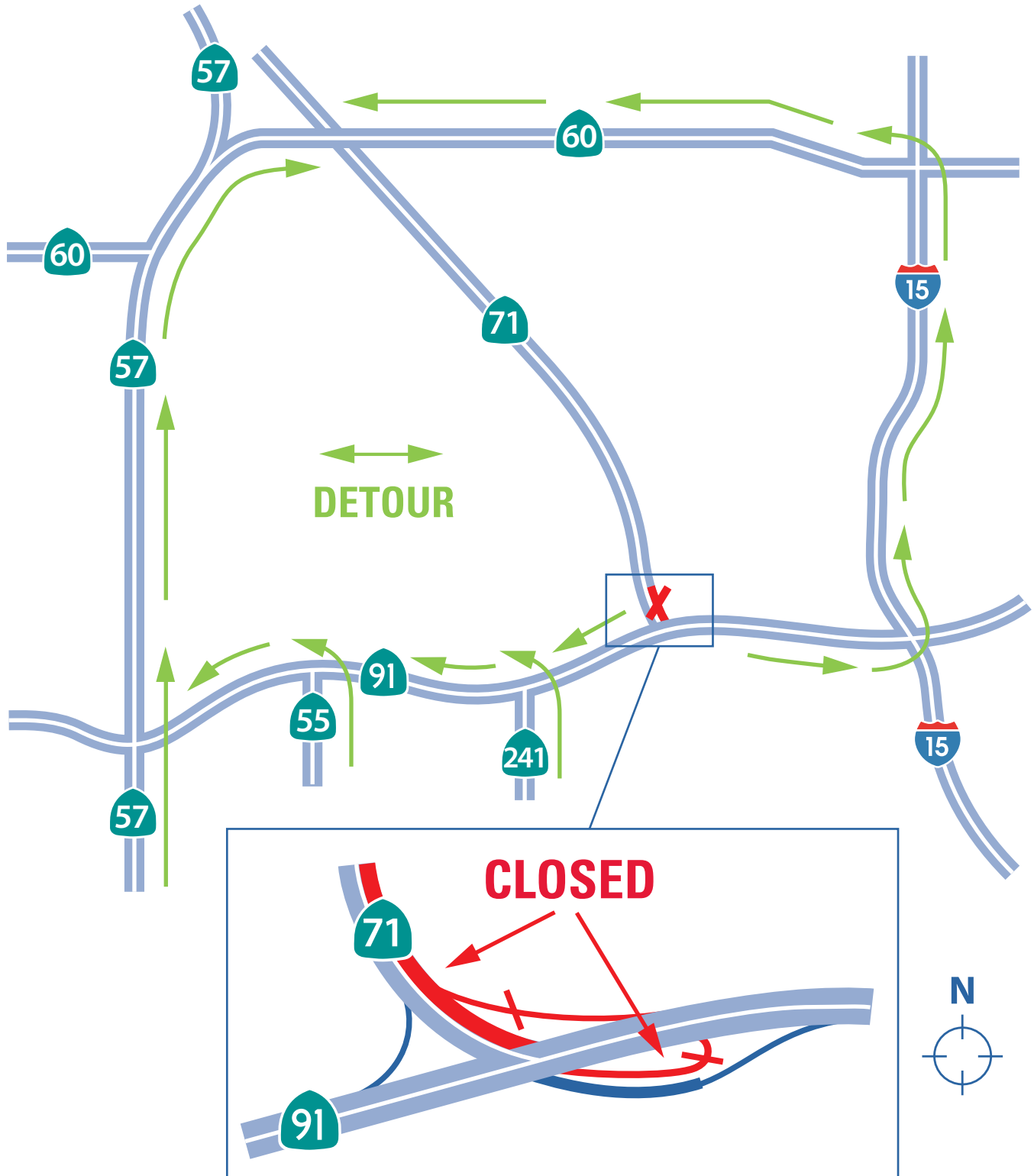

91 PROJECT

Roadway Lowering Stages, Serfas Club Drive/Auto Center Drive

NOTE: EB 91 Serfas Club Drive on-ramp closed in September 2015 for about 15 months. Only NB Maple Street bridge travel available. Detour route for SB Maple Street bridge travel is Smith Street.

First Stage Lowering

WB 91 Off- and On-Ramps Closed
Serfas Club Undercrossing Closed
EB Off-Ramp Closed
Friday, February 26 at 9 pm to
Monday, February 29 at 4 am
(55 Hours - Weekend)

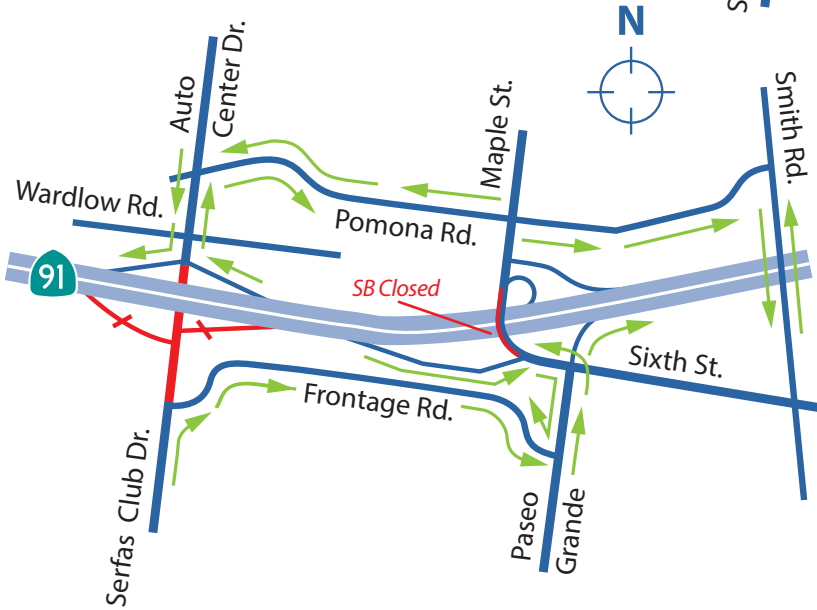
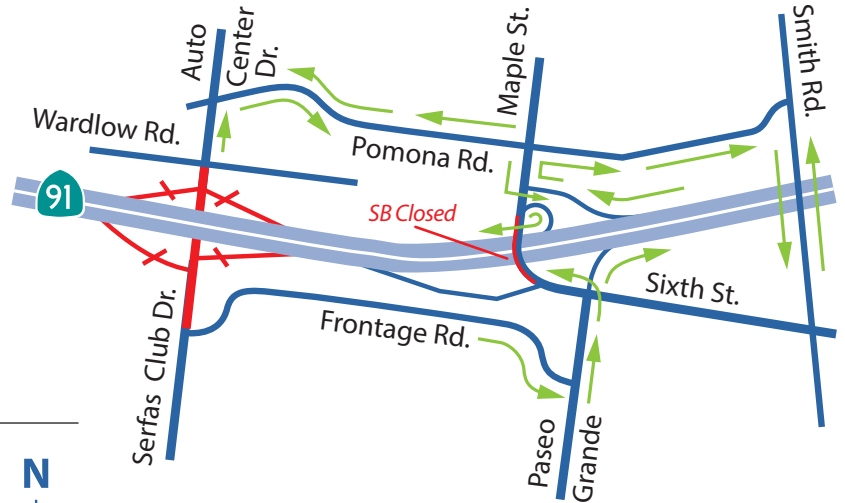

Second Stage Lowering

EB 91 Off-Ramp Closed
Serfas Club Undercrossing Closed
Friday, March 18, at 9 pm to
Monday, March 21 at 4 am
(55 Hours - Weekend)

Third Stage Lowering

Serfas Club Undercrossing Closed
Friday, March 25, at 9 pm to
Monday, April 4 at 4 am
(9 Days - CNUSD Spring Break)
Starting Monday, March 21 to May 15, 2016:
Pomona Rd. WB Closed Nightly, 10 pm - 5 am
Pomona Rd. EB Closed Continuously

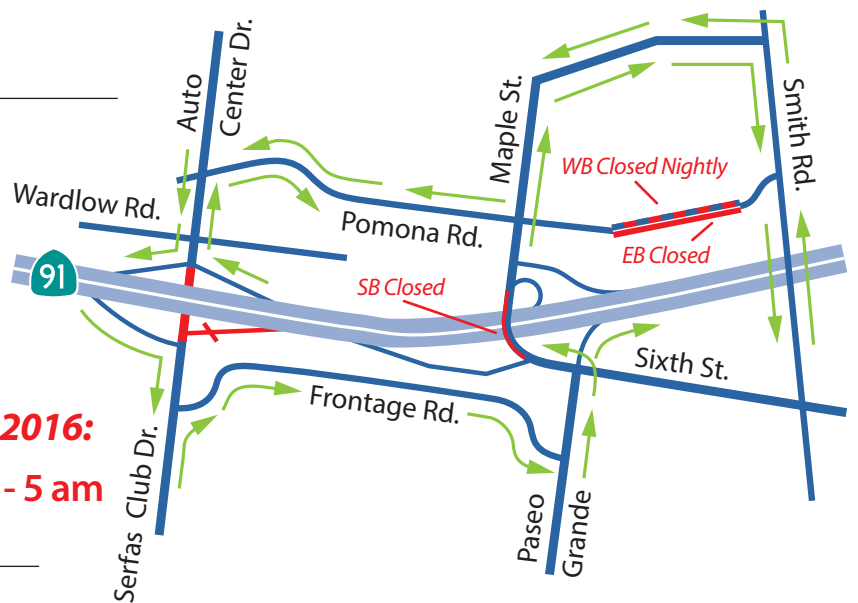

DETOUR / DESVÍO →